

- GENERAL NOTES**
1. All work indicated on this plan shall be done in accordance with the specifications for Street and Highway Engineering, 1938, as amended, and the specifications for the City of San Bernardino, 1938, as amended.
  2. All work shall be done in accordance with the specifications for the City of San Bernardino, 1938, as amended.
  3. All work shall be done in accordance with the specifications for the City of San Bernardino, 1938, as amended.
  4. All work shall be done in accordance with the specifications for the City of San Bernardino, 1938, as amended.
  5. All work shall be done in accordance with the specifications for the City of San Bernardino, 1938, as amended.

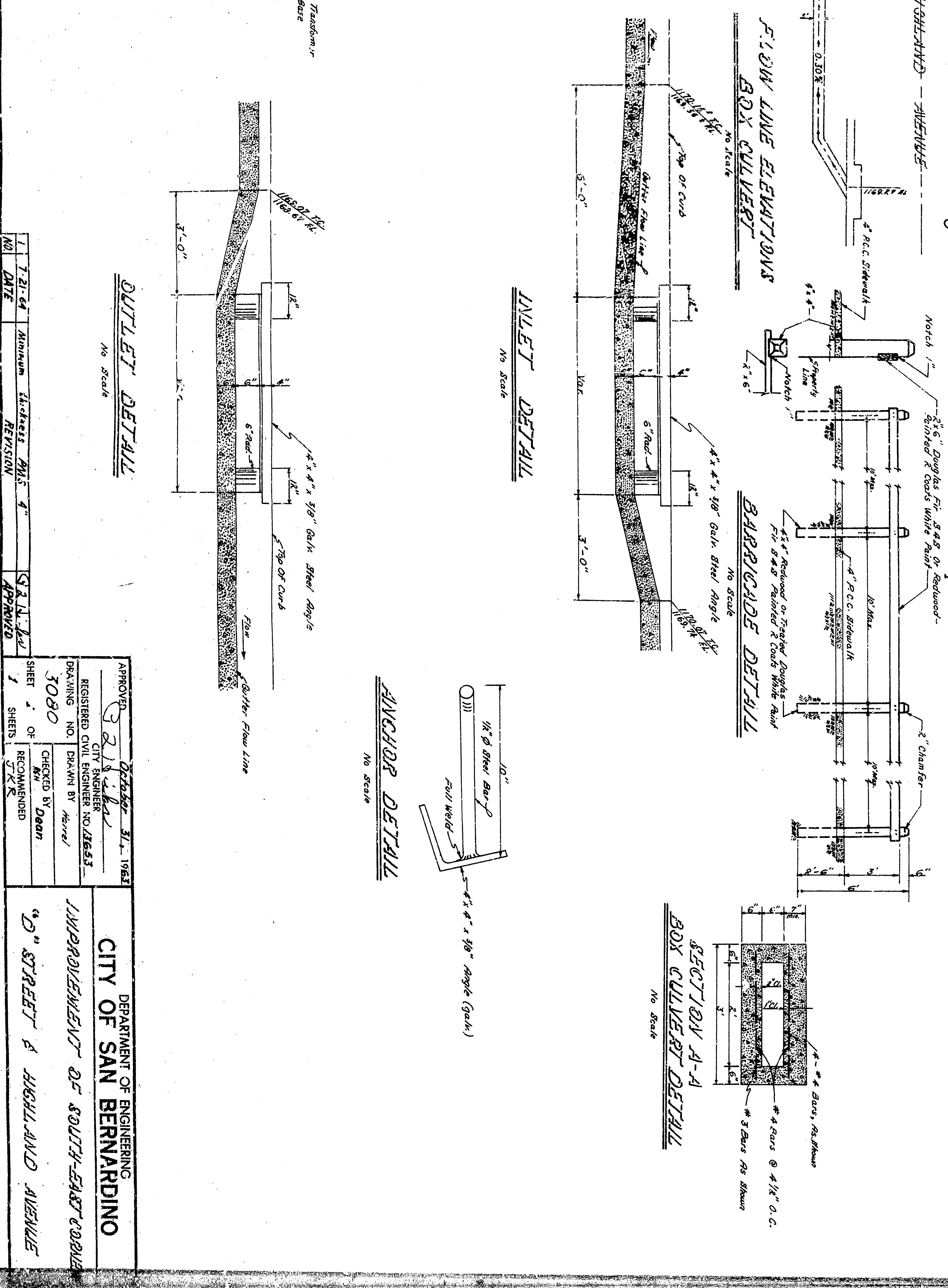
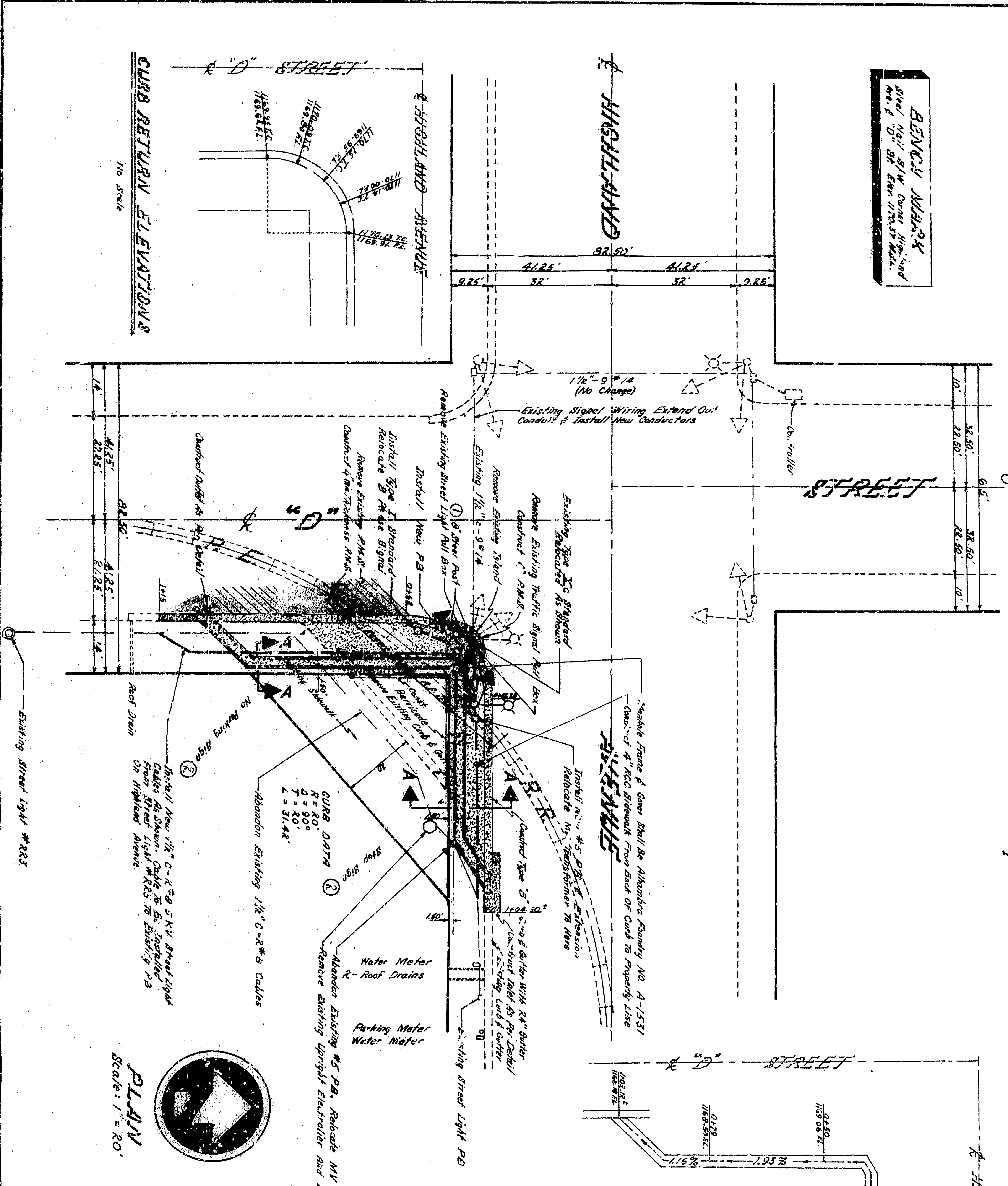

NO.	DATE	REVISION
1	11.18.52	MINIMUM
2		CHANGES
3		REVISION

APPROVED: *[Signature]* 11.18.52  
 REGISTERED CIVIL ENGINEER NO. 21853  
 DRAWING NO. 1080  
 CHECKED BY: Dean  
 DESIGNED BY: [Name]  
 CITY OF SAN BERNARDINO  
 DEPARTMENT OF ENGINEERING  
 IMPROVEMENT OF SOUTH-EAST CORNER  
 "D" STREET & HIGHLAND AVENUE